

Power Burner

FIREMAGIC®

BUILT WITH PASSION. OWNED WITH PRIDE.

Experience the heat intensity when using the Fire Magic® Power Burner



WHY USE A POWER BURNER?

- Companion side cooker for added versatility.
- Up to 60,000 BTU's of cooking power, knob on left for inner burner has a range of 3,000-15,000 BTU's. Larger knob on right for outer burner has a maximum of 45,000 BTU's.
- Back-lit control knobs for added aesthetics and visibility.
- The **10" diameter, Heat Concentrating Flame Collimator** concentrates heat in the center 22% of unit (for wok cooking, turkey frying or any other dish that needs concentrated heat).
- Power switch for easy operation.
- Power Burner Plugs in to the Echelon Diamond or Aurora Grill transformer for power.
- Also available in a battery operated version.



Echelon Power Burner with cast iron grids. Also available with stainless steel grids.



Heat Concentrating Flame Collimator



Aurora Power Burner with stainless steel grids. Also available with cast iron grids.



Power Burner shown as offset in grill



Heat Concentrating Flame Collimator

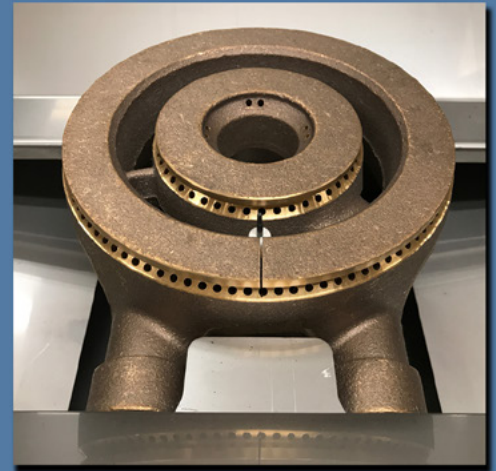

Double Burner

Griddle Adapter for Power Burners (Part #3683)

New Griddle Adapter allows you to use **both sizes** of Stainless Steel Griddles on your Fire Magic® Power Burner.



Power Burner shown with Small S.S. Griddle and New Griddle Adapter



Power Burner shown with Griddle Adapter



Power Burner shown with Large S.S. Griddle and New Griddle Adapter



Stainless Steel Griddle Adapter

Model# 3683

CAUTION: The griddle and adapter will remain hot for some time after use. Allow time for it to cool before handling and/or cleaning.

This griddle adapter is for use with a Fire Magic Griddle to make compatible with Fire Magic Power Burners and Double Searing Stations. Fire Magic griddle sold separately. To install, follow the steps below.

CAUTION: Ensure the appliance is OFF and completely cool.

1. Remove cooking grid from grill accessory.
2. Place the griddle adapter onto the grill accessory as shown in Fig. 1-1.
3. Place the griddle onto the adapter (see Fig. 1-1).

Note: The adapter has notches located on the top rear to allow for proper griddle placement.

4. Install the griddle drip tray as shown in Fig. 1-2, and use the griddle as directed in the griddle owner's manual.

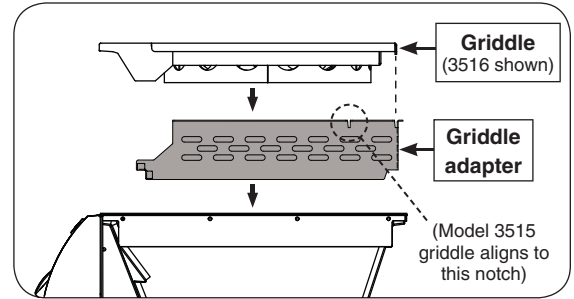
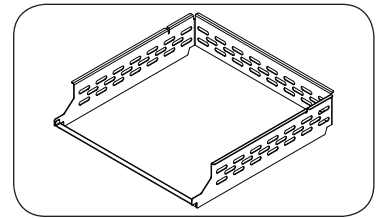

Fig. 1-1 Install adapter and griddle

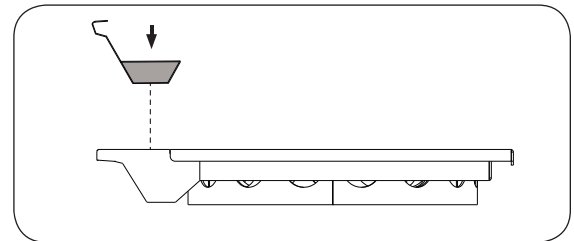

Fig. 1-2 Install griddle drip tray